

1004-0160...0400, 1004 (TSK) 系列可倾回转工作台
1004-0160...0400, 1004 (TSK) SERIES TILTING ROTARY TABLE

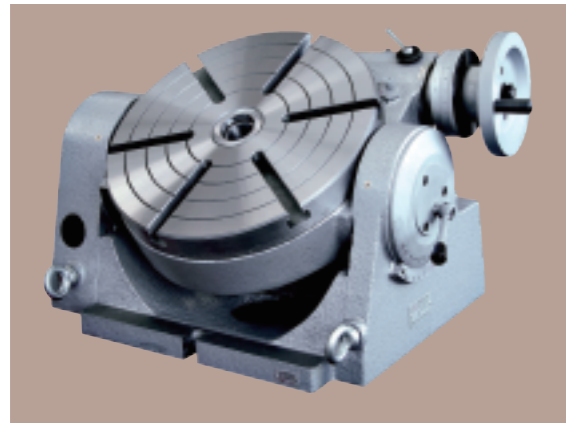

1004(TSK)系列可倾回转工作台是铣床、镗床、钻床的主要附件之一，主要用于加工斜孔或通过一次装夹定位加工除支撑面以外要求从工件中的各方位进行加工的工件。另外，工作台可以垂直位置与尾座配合使用，对工件进行圆周分度钻削和铣削。

工作台可从水平位置到垂直位置间(0°~90°)任意调整并锁紧。每个规格的转台分别提供连接不同卡盘的法兰盘，作为特殊订货，并将法兰盘独立包装。另外，为特殊订货所提供的分度盘附件可实现由2至66间所有整数和由67到132间能被2, 3和5整除的所有整数的分度。

THE 1004(TSK) series tilting rotary table are one of main accessories for milling, boring and drilling machines. They can be used for machining the oblique hole or surface and hole of compound angle at one set-up. Besides this, it is so designed as to be used in a vertical position to carry out center work with a tailstock. This table can be tilted to any position from 0° to 90° and locked.

A flange for connecting scroll chuck is special supplied and packed separately. For special order, the dividing plates accessory allows the operator to accurately divide the 360° rotation of the clamping surface into divisions of 2 through 66, and all divisible of 2, 3 and 5 from 67-132.

主要规格和参数: Main specifications

| 规格 Specifications 项目 Items | 1004-0160 (TSK160) | 1004-0200 (TSK200) | 1004-0250 (TSK250) | 1004-0320 (TSK320) | 1004-0400 (TSK400) |
|----------------------------------------------------|-----------------------|-----------------------|-----------------------|-----------------------|-----------------------|
| 工作台面直径 Diameter of table mm | φ 160 | φ 200 | φ 250 | φ 320 | φ 400 |
| 台面中心孔锥度(莫氏) Diameter of the center hole | 2# | 3# | 3# | 4# | 4# |
| 台面定位孔直径 Diameter of the center hole mm | φ 25X6 | φ 30X6 | φ 30X6 | φ 40X10 | φ 40X10 |
| 台面T型槽宽度 Width of T-slot mm | 10 | 12 | 12 | 14 | 14 |
| 蜗轮副模数 Modules of worm and worm gear | 1.5 | 1.75 | 2 | 2.5 | 3.5 |
| 定位键宽度 Width of locating key mm | 12 | 14 | 14 | 18 | 18 |
| 台面T型槽相邻角度 Adjacent angle of T-slot | 90° | 90° | 60° | 60° | 60° |
| 蜗轮副传动比 Transmission ratio of the worm gear | 1: 90 | 1: 90 | 1: 90 | 1: 90 | 1: 90 |
| 工作台圆周刻度 Graduation of the table | 360° | 360° | 360° | 360° | 360° |
| 工作台可倾角度 Tilting angle | 0°~90° | 0°~90° | 0°~90° | 0°~90° | 0°~90° |
| 轮台手轮刻度值 Readout of the handwheel | 1' | 1' | 1' | 1' | 1' |
| 游标最小示值 Minimum value of vernier | 10" | 10" | 10" | 10" | 10" |
| 可倾游标最小示值 Minimum reading of the tilting vernier | 2' | 2' | 2' | 2' | 2' |
| 分度精度 Indexing accuracy | 80" | 60" | 60" | 60" | 60" |
| 最大承载(卧式) Max.bearing(with table Hor.)Kg | 100 | 150 | 200 | 250 | 300 |
| 最大承载(立式) Max.bearing(with table Vert.)Kg | 50 | 75 | 100 | 125 | 150 |
| 净重 Net weight Kg | 36 | 57 | 80 | 135 | 280 |
| 毛重 Gross weight Kg | 44 | 67 | 93 | 150 | 305 |
| 箱体尺寸 Case dimensions mm | 425X380X300 | 492X423X306 | 550X430X330 | 630X490X395 | 830X600X460 |
| 可配卡盘 Matching chuck | K11125 | K11160 | K11200 | K11250 | K11325 |

1004-0160...0400, 1004 (TSK) 系列可倾回转工作台
1004-0160...0400, 1004 (TSK) SERIES TILTING ROTARY TABLE

1004-0160...0400, 1004 (TSK) 系列可倾回转工作台安装尺寸图 Dimensional Sketch

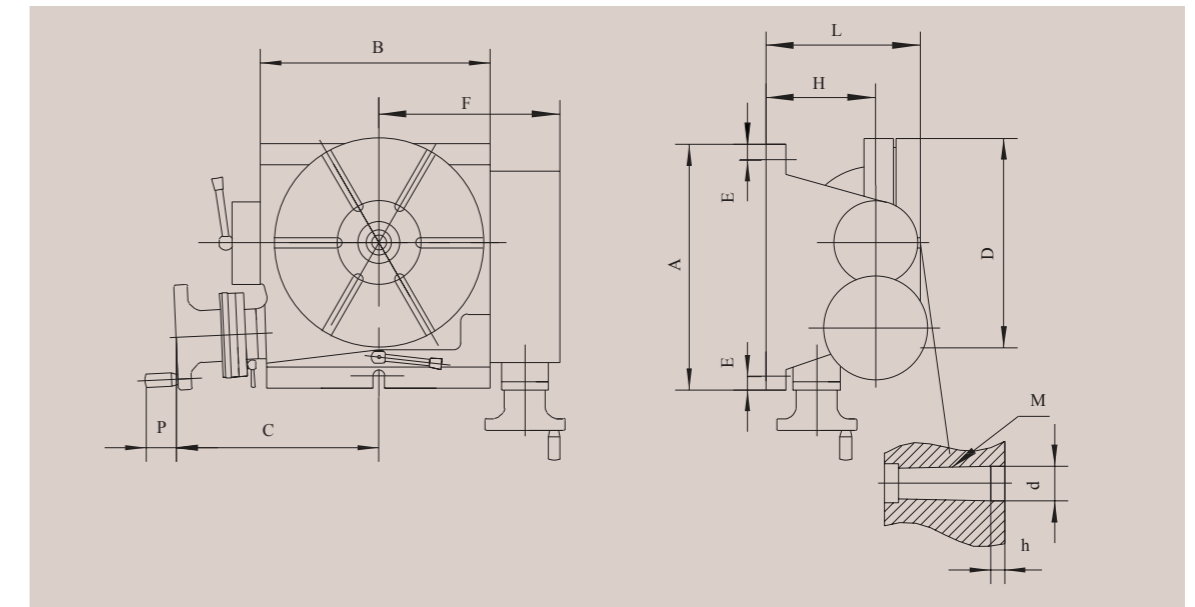

1004-0100...0400, 1004 (TSK) 系列回转工作台安装尺寸参数: Installation sketch and dimensions

| | 1004-0160 (TSK160) | 1004-0200 (TSK200) | 1004-0250 (TSK250) | 1004-0320 (TSK320) | 1004-0400 (TSK400) |
|---|-----------------------|-----------------------|-----------------------|-----------------------|-----------------------|
| A | 255 | 296 | 310 | 380 | 500 |
| B | 172 | 213 | 252 | 322 | 400 |
| C | 168 | 186 | 235 | 252 | 306 |
| D | φ 160 | φ 200 | φ 250 | φ 320 | φ 400 |
| E | 11 | 14 | 14 | 16 | 16 |
| F | 138 | 175.5 | 199 | 241 | 295 |
| H | 100 | 120 | 140 | 175 | 217 |
| L | 160 | 180 | 205 | 255 | 320 |
| M | MT2 | MT2 | MT3 | MT3 | MT4 |
| P | 40 | 40 | 40 | 40 | 50 |
| d | φ 25 | φ 30 | φ 30 | φ 40 | φ 40 |
| h | 6 | 6 | 6 | 10 | 10 |