

1247-0001...0008 5C 胀力夹头
 1247-0001...0008 5C Expanding Collets

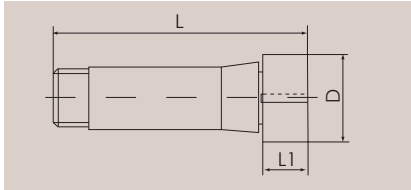

Stock No	L(mm)	D(mm)	L1(mm)
1247-0001	114	11.9	25.4
1247-0002	114	20.32	25.4
1247-0003	114	36.5	25.4
1247-0004	114	49.2	25.4
1247-0005	118 1/2	13.15	30.2
1247-0006	118 1/2	21.4	30.2
1247-0007	118 1/2	38.1	29.2
1247-0008	118 1/2	54	29.2

Fit any standard 5C spindle. Precision ground. Soft head for easy machining. Internal thread 1.041"-24, external thread 1.242"-20

HITECH (Qingdao)
ENTERPRISES INC