

DIN Flange End Mill Holders

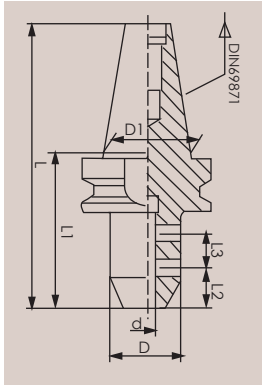

Features:
 Suitable for CNC RPM \geq 12000
 RPM \geq 20000 balance
 toolholders are available

DIN69871.A

Stock No.	Tapper	d(in)	L1(mm)	L(mm)	D(mm)	D1(mm)	L2(mm)	L3(mm)
1173-3001	A30	1/4"	50	97.8	27	31.75	12	
1173-3002	A30	5/16"	50	97.8	30	31.75	16	
1173-3003	A30	3/8"	50	97.8	32	31.75	19	
1173-3004	A30	1/2"	50	97.8	35	31.75	23	
1173-3005	A30	5/8"	63	110.8	41	31.75	23	
1173-4001	A40	1/4"	50	118.4	27	44.45	12	
1173-4002	A40	5/16"	50	118.4	30	44.45	16	
1173-4003	A40	3/8"	50	118.4	32	44.45	19	
1173-4004	A40	1/2"	50	118.4	35	44.45	22	
1173-4005	A40	5/8"	63	131.4	41	44.45	23	
1173-4006	A40	3/4"	63	131.4	44.5	44.45	25	
1173-4007	A40	1"	100	168.4	55	44.45	28	25.4
1173-4008	A40	1-1/4"	100	168.4	62	44.45	28	
1173-5001	A50	1/4"	63	164.75	27	69.85	12	
1173-5002	A50	5/16"	63	164.75	30	69.85	16	
1173-5003	A50	3/8"	63	164.75	32	69.85	19	
1173-5004	A50	1/2"	63	164.75	35	69.85	22	
1173-5005	A50	5/8"	63	164.75	41	69.85	23	
1173-5006	A50	3/4"	63	164.75	44.5	69.85	28	25.4
1173-5007	A50	1"	80	181.75	55	69.85	28	25.4
1173-5008	A50	1-1/4"	100	201.75	62	69.85	28	25.4
1173-5009	A50	1-1/2"	100	201.75	68	69.85	28	36.5
1173-5010	A50	2"	125	226.75	97	69.85	30	36.5
1173-5011	A50	2-1/2"	150	250.75	125	69.85	30	36.5

HITECH_(Qingdao) ENTERPRISES INC