

DIN taper Drill Chuck Arbors

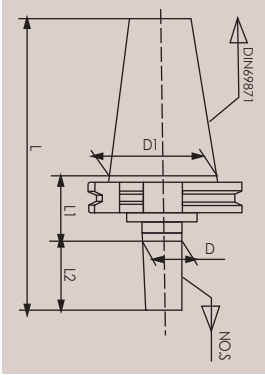

Features:
 Suitable for CNC RPM \geq 12000
 RPM \geq 20000 balance
 toolholders are available

Stock No.	DIN69871. A-NO.S-L1	L2(mm)	L(mm)	D(mm)	D1(mm)	Drawbar Thread	Weight(Kg)
1170-4001	DIN69871.A40-J0-32	11.112	111.5	6.35	44.45	M16	1.55
1170-4002	DIN69871.A40-J1-32	16.669	117	9.754	44.45	M16	1.55
1170-4003	DIN69871.A40-J2-32	22.225	122.6	14.199	44.45	M16	1.60
1170-4004	DIN69871.A40-J2S-32	19.05	119.5	13.94	44.45	M16	1.60
1170-4005	DIN69871.A40-J3-32	30.956	131.4	20.599	44.45	M16	1.62
1170-4006	DIN69871.A40-J4-32	42.069	142.5	28.55	44.45	M16	1.65
1170-4007	DIN69871.A40-J5-32	47.625	148	35.89	44.45	M16	1.70
1170-4008	DIN69871.A40-J6-32	25.4	125.8	17.17	44.45	M16	1.60
1170-4009	DIN69871.A40-J33-32	25.4	125.8	15.85	44.45	M16	1.60
1170-4010	DIN69871.A40-B6-32	10	110.4	6.35	44.45	M16	1.62
1170-4011	DIN69871.A40-B10-32	14.5	114.9	10.094	44.45	M16	1.65
1170-4012	DIN69871.A40-B10-45	14.5	127.9	10.094	44.45	M16	1.67
1170-4013	DIN69871.A40-B12-32	18.5	118.9	12.065	44.45	M16	1.70
1170-4014	DIN69871.A40-B12-80	18.5	166.9	12.065	44.45	M16	1.74
1170-4015	DIN69871.A40-B16-26	24	118.4	15.733	44.45	M16	1.55
1170-4016	DIN69871.A40-B16-32	24	124.4	15.733	44.45	M16	1.60
1170-4017	DIN69871.A40-B16-45	24	137.4	15.733	44.45	M16	1.65
1170-4018	DIN69871.A40-B18-32	32	132.4	17.78	44.45	M16	1.62
1170-4019	DIN69871.A40-B18-45	32	145.4	17.78	44.45	M16	1.67
1170-4020	DIN69871.A40-B22-32	40.5	140.9	21.793	44.45	M16	1.65
1170-4021	DIN69871.A40-B24-32	50.5	150.9	23.825	44.45	M16	1.67
1170-5001	DIN69871.A50-B16-45	24	170.74	15.733	69.85	M24	2.40

HITECH_(Qingdao) ENTERPRISES INC